

liczba pokoi **3**

piętro **1**

budynek **A**

NR

**A3**

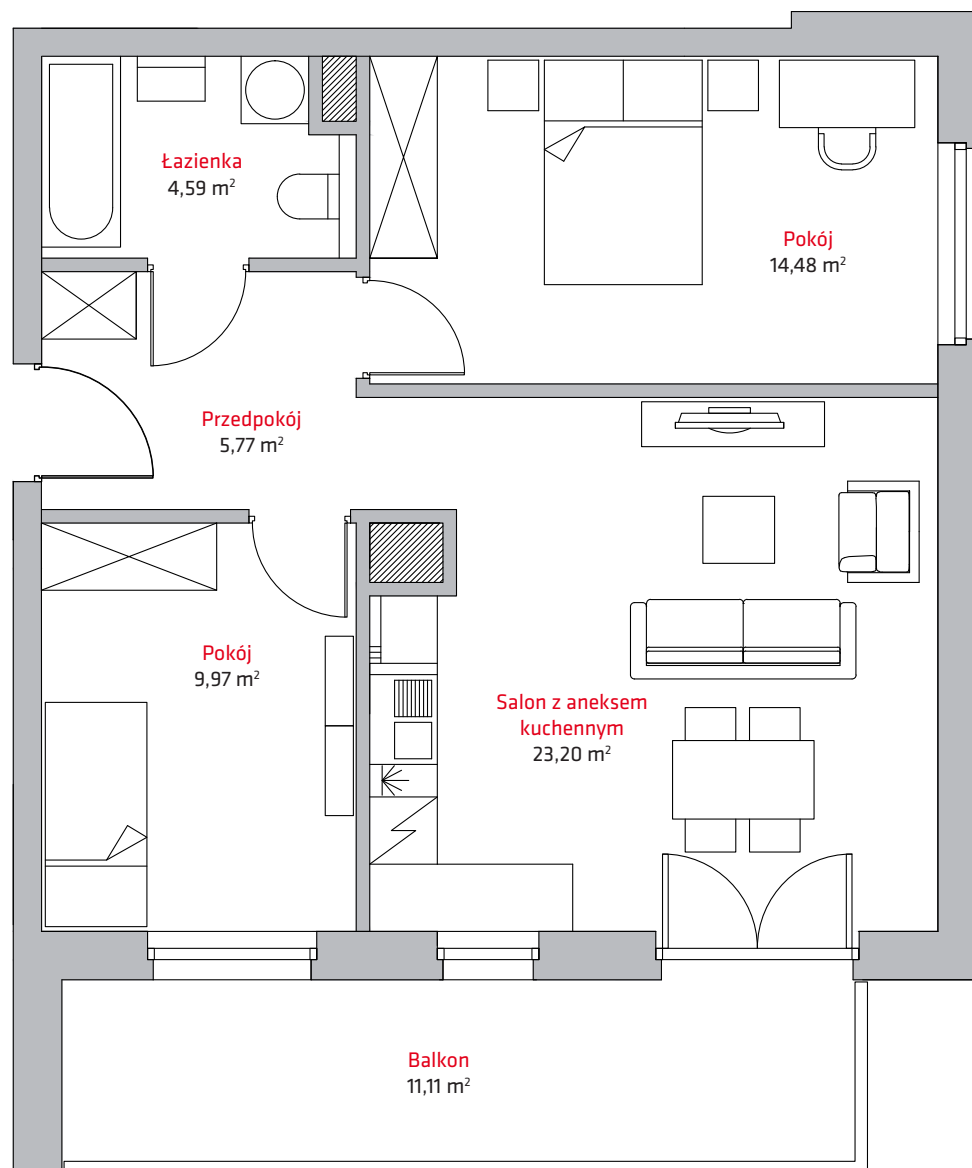

|             |                       |                            |
|-------------|-----------------------|----------------------------|
| 1           | Przedpokój .....      | 5,77 m <sup>2</sup>        |
| 2           | Łazienka .....        | 4,59 m <sup>2</sup>        |
| 3           | Pokój.....            | 14,48 m <sup>2</sup>       |
| 4           | Salon z aneksem kuch. | 23,20 m <sup>2</sup>       |
| 5           | Pokój.....            | 9,97 m <sup>2</sup>        |
| <b>SUMA</b> |                       | <b>58,01 m<sup>2</sup></b> |
|             | Balkon .....          | 11,11 m <sup>2</sup>       |

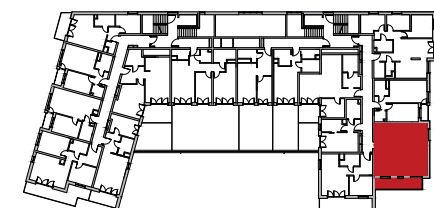
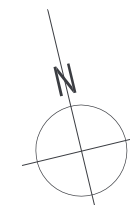

**Kontakt:**

tel. + 48 604 706 792

+ 48 693 620 372

email: [biuro@vermelo.pl](mailto:biuro@vermelo.pl)

[www.vermelo.pl](http://www.vermelo.pl)